

Quartz Crystal

SMD-version

part no.	12.84816
model	KX - 4
frequency	25.0 MHz
mode	fundamental
operating temperature	-20° ~ +70°C
frequency tolerance at +25°C	±30 ppm
temperature tolerance at -20° ~ +70°C	±50 ppm
load capacitance C_L	8 pF
series resistance R1 (ESR) max.	150 Ohm
aging at +25°C (first year) max.	±2 ppm
shunt capacitance C_0 max.	3.0 pF
drive level max.	50 μ W
contents of reel	1000 pcs.

Dimensions (mm):

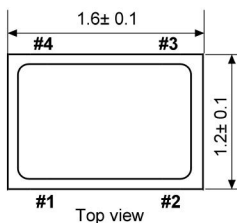

Top view

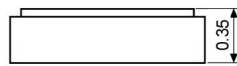

Side view

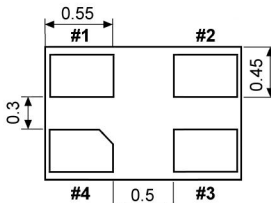

Bottom view

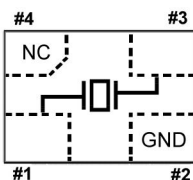

Top view connections

Suggested soldering pad:

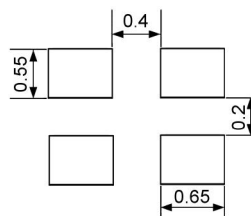

Reflow soldering condition:

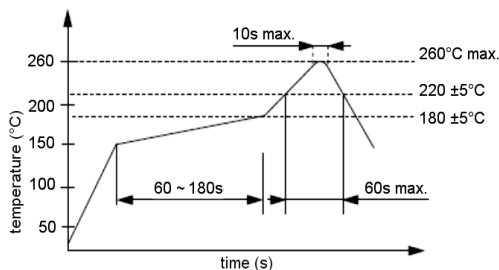

Tape specification:

