

Recommended PCB Layout

Tolerance: ± 0.05

▨ Solder Area

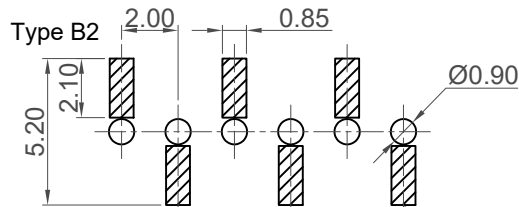
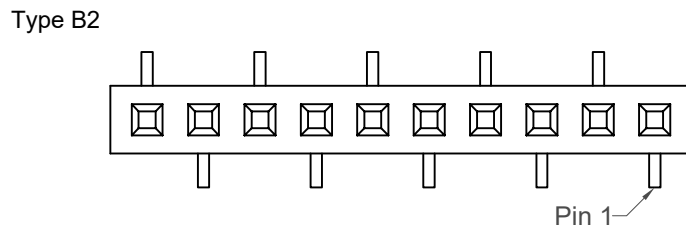

Recommended PCB Layout

Tolerance: ± 0.05

▨ Solder Area

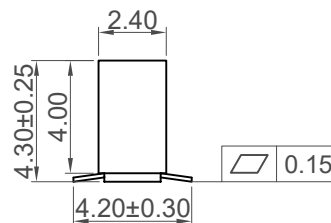
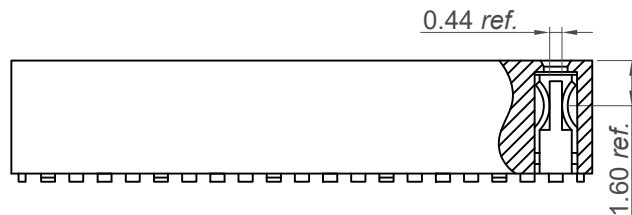

Ordering Grid

BF090-XX-X-X-X-X

No. of Contacts
02 to 40

Contact Plating

A = Gold Flash All Over (Standard)

B = Selective Gold Flash Contact Area/Tin On Tail

C = Tin All Over

G = 10 μ " Gold Contact Area/Tin On Tail

I = 30 μ " Gold Contact Area/Tin On Tail

Type

1 = Type B1

2 = Type B2

Packing Options

C = Tape & Reel with Film(Standard)

B = Tape & Reel with Cap

D = Tube

E = Tube with Cap

F = Tube with Film

Insulator Material

N = Nylon 6T(Standard)

L = LCP

9 = Nylon 9T

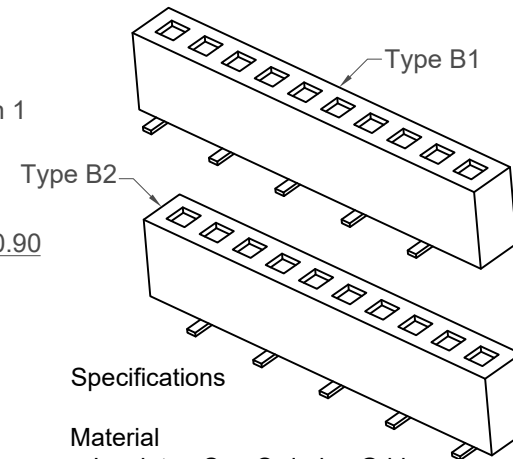

Specifications

Material

Insulator: See Ordering Grid

Contact: Copper Alloy

Plating

See Ordering Grid

Electrical

Current Rating: 2 Amp *per pin*

Contact Resistance: 20 m Ω max.

Insulating Resistance: 1000 M Ω min.

Dielectric Withstand Voltage: 500V AC

Mechanical & Environmental

Operating Temperature: -40°C to +105°C

Soldering Process:

Nylon 6T/9T

IR Reflow: 260°C for 10 sec

Wave: 230°C for 5-10 sec

Manual Solder: 350°C for 3-5 sec

LCP

IR Reflow: 260°C for 10 sec

Wave: 250°C for 5-10 sec

Manual Solder: 350°C for 3-5 sec

Mates with(Subject to pin length)

BF020 BF021 BF025 BF035 BF036

BF040 BF130

No. of Contacts	Dimensions	
	A	B
2	2.0	4.6
3	4.0	6.6
4	6.0	8.6
5	8.0	10.6
6	10.0	12.6
7	12.0	14.6
8	14.0	16.6
9	16.0	18.6
10	18.0	20.6
11	20.0	22.6
12	22.0	24.6
13	24.0	26.6
14	26.0	28.6
15	28.0	30.6
16	30.0	32.6
17	32.0	34.6
18	34.0	36.6
19	36.0	38.6
20	38.0	40.6
21	40.0	42.6
22	42.0	44.6
23	44.0	46.6
24	46.0	48.6
25	48.0	50.6
26	50.0	52.6
27	52.0	54.6
28	54.0	56.6
29	56.0	58.6
30	58.0	60.6
31	60.0	62.6
32	62.0	64.6
33	64.0	66.6
34	66.0	68.6
35	68.0	70.6
36	70.0	72.6
37	72.0	74.6
38	74.0	76.6
39	76.0	78.6
40	78.0	80.6

Part Number		Product Description	
BF090		2.00mm Pitch Socket, Single Row, Surface Mount, Dual Entry	
Drawing Date		31th October 2007	
By	KY	Tolerances (Except as Noted)	Units: Metric (mm)
Detail	BF090 F PCN	Length: X. ± 0.30	Angle: X.° $\pm 5^\circ$
Revision	F1	X.X ± 0.20	X.X° $\pm 3^\circ$
Date	12/09/24	X.XX ± 0.15	X.XX° $\pm 2^\circ$
		X.XXX ± 0.10	X.XXX° $\pm 1^\circ$



This drawing is confidential and copyright of Global Connector Technology, Ltd (GCT). This drawing must not be copied or disclosed without written consent. E & OE

GCT

www.gct.co

Not to Scale Drawn By LYH Sheet No. 1/1